



The LT8 consolidates ADIGE's leadership in the lasertube cutting increasing the gap with other existing systems

## LT8 the new frontier in **lasertube systems**

Technology

INSPIRED FOR TUBE



### **Performance**

The LT8 combines the utmost flexibility and excellent performance in a single system. The vast dimensional range of tubes that can be worked (from 12 to 225 mm O.D. and up to 8,5m in length) makes it possible to cover a wide spectrum of services. At the same time, the performances that can be achieved are currently unmatched even on small size tubes.

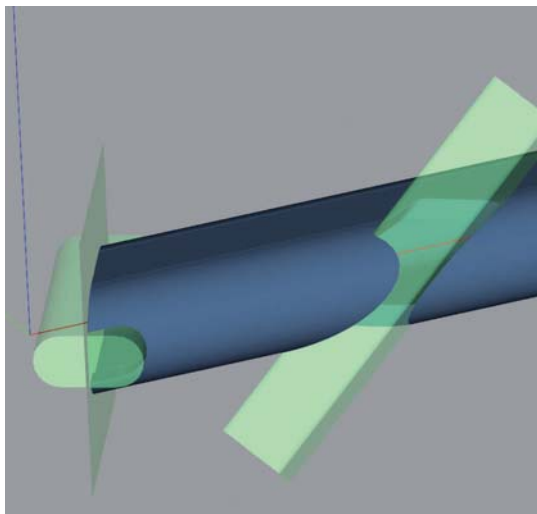

### **Innovative machine software**

The LT8 programming software has been designed using innovative criteria. Working cycles have been optimised to achieve excellent performance and an "intelligent" on-board operator user-friendly interface guides the operator.

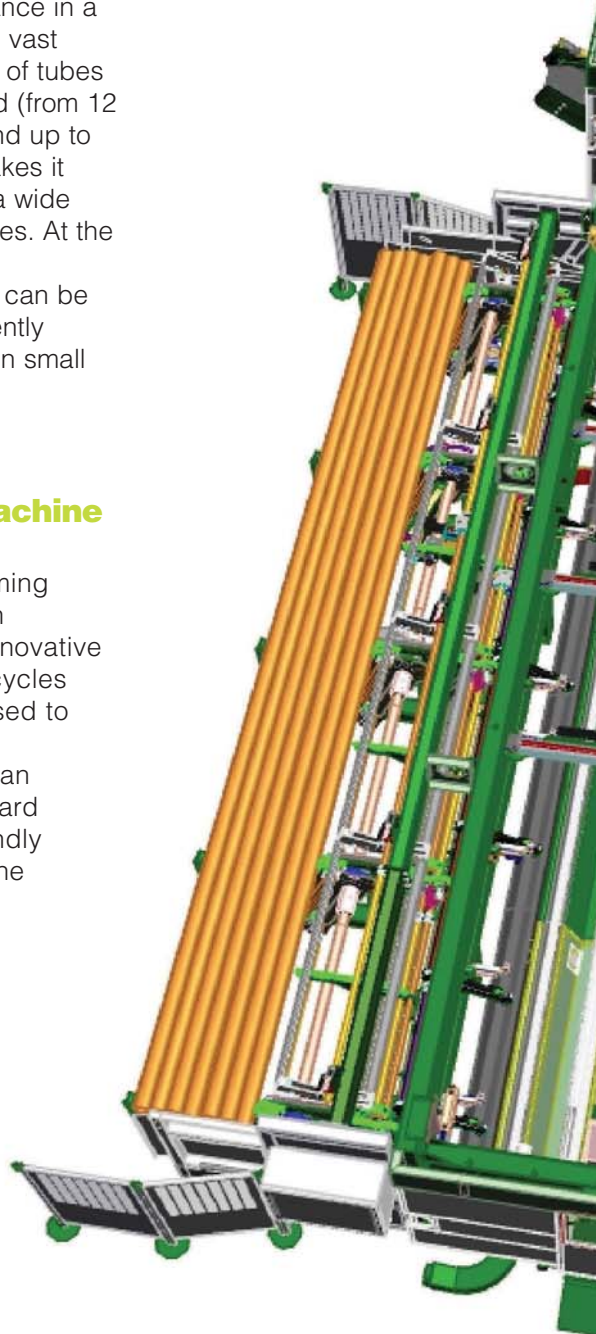

#### **ADIGE S.P.A.**

Via per Barco, 11  
38056 Levico Terme (TN) Italy  
tel. +39 0461 729000  
fax +39 0461 701410  
e-mail: [vendite@adige.it](mailto:vendite@adige.it)



### Unloading system

Unloading from a lasertube system is a delicate phase, which LT8 handles extremely well thanks to various options that consider the variability of tube sizes and geometry to be processed. A special centring feature allows superior consistency on long pieces while a separate conveyor belt guarantees maximum productivity.



### 3D head

With the increase in size and thickness of tubes that can be processed, the need for a 3D cutting head often becomes an indispensable tool to fully meet the user's requirements. The LT8 is equipped with a fast moving "3D" head, which is extremely effective and precise in cutting a considerable thickness.



### Loading systems

The idea was to provide the LT8 with several distinct loading stations – front and rear. They allow to follow the need of the operator either by interrupting a bulky production temporarily so that a small number of tubes can be cut urgently or so that a production batch can be prepared while the previous one is still being processed.

